

**INTEROBIZ**

[www.interobiz.ro](http://www.interobiz.ro)

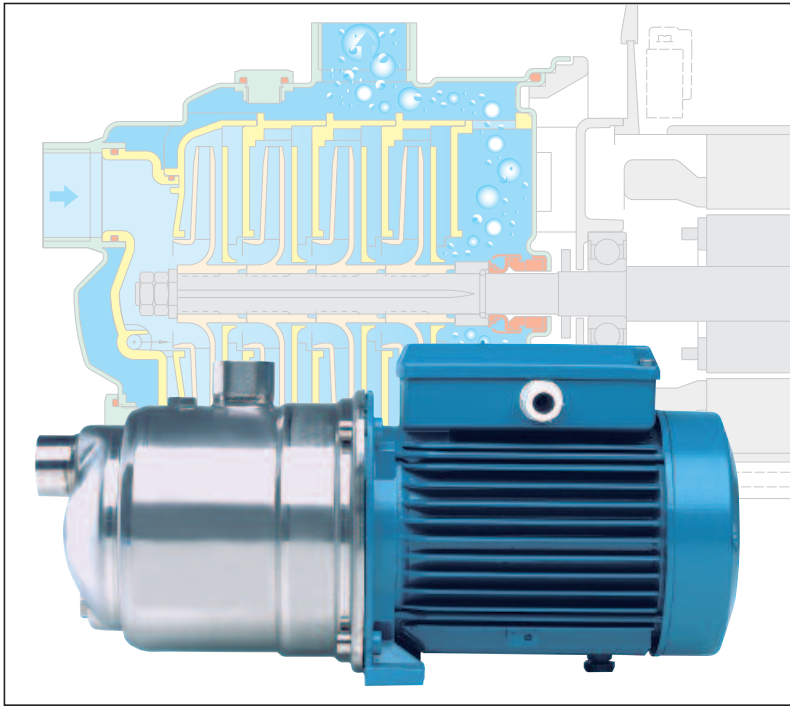

### Construction

Horizontal multi-stage, self-priming, close coupled pump.  
Single-piece barrel casing in chrome-nickel stainless steel, with front suction port above pumps axis and radial delivery at top.  
Stages in Noryl.

### Applications

For water supply.  
For domestic use, for garden use and irrigation.

### Operating conditions

Liquid temperature: 0 °C to +35 °C.  
Ambient temperature up to +40 °C.  
Suction lift up to 8 m.  
Maximum permissible pressure in the pump casing: 8 bar.  
Continuous duty.

### Materials

Component	Material
Pump casing	Cr-Ni steel 1.4301 EN 10088 (AISI 304)
Casing cover	Cr-Ni steel 1.4301 EN 10088 (AISI 304)
Pump Shaft	Chrome steel 1.4104 EN 10088 (AISI 430) Cr-Ni steel 1.4305 EN 10088 (AISI 303) for MXA 205,405
Plug	Cr-Ni steel 1.4305 EN 10088 (AISI 303)
Suction casing	PPO-GF20 (Noryl)
Stage casing	PPO-GF20 (Noryl)
Impeller	PPO-GF20 (Noryl)
Mechanical seal	Carbon - Ceramic - NBR

### Motor

2-pole induction motor, 50 Hz (n = 2800 1/min).  
MXA: three-phase 230/400 V ± 10%.  
MXAM: single-phase 230 V ± 10%, with thermal protector.  
Capacitor inside the terminal box.  
Insulation class F.  
Protection IP 54.  
Constructed in accordance with: EN 60335-2-41.

### Characteristic curves n ≈ 2800 rpm

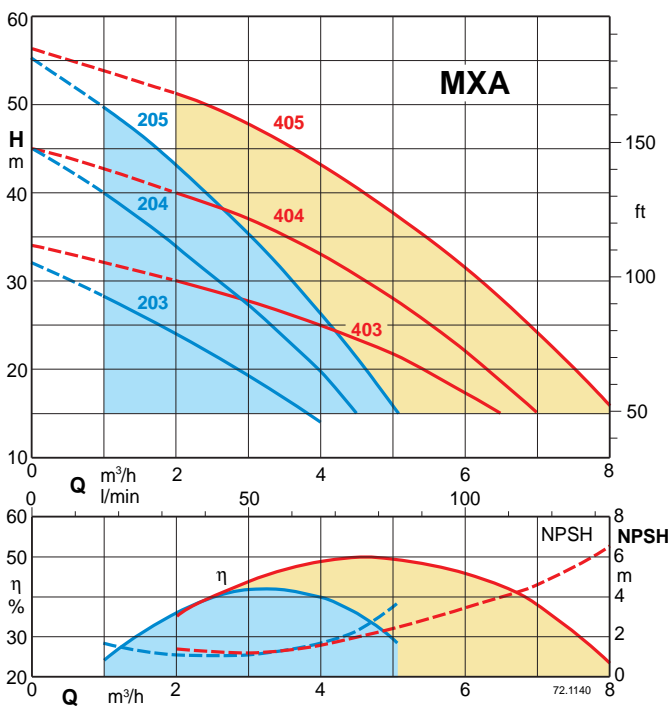

### Self-priming capability

H<sub>2</sub>O, T = 20°C,  
Pa = 1000 hPa (mbar)  
50 Hz (n = 2800 1/min)

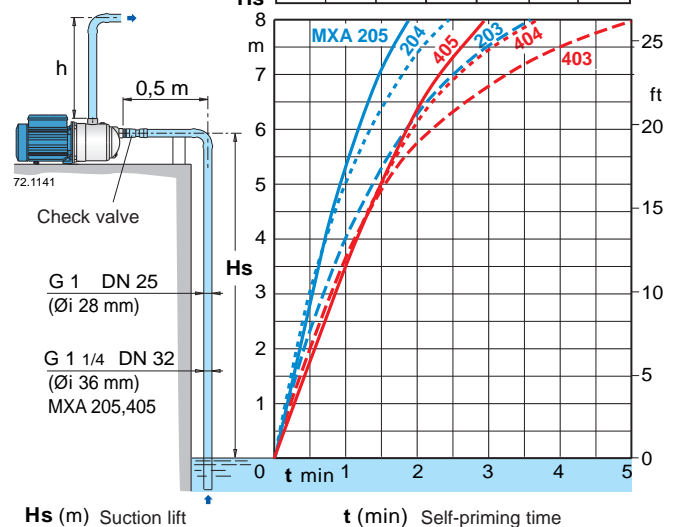

### Performance $n \approx 2800 \text{ rpm}$

	3 ~ 230 V 400 V		1 ~ 230 V		P <sub>1</sub>		P <sub>2</sub>		Q								
	A	A	A	kW	kW	HP	m <sup>3</sup> /h	l/min		0	1	2	3	4	4,5	5	
<b>MXA 203</b>	2,4	1,4	<b>MXAM 203</b>	3	0,63	0,45	0,6	<b>H</b>	m	32	28	24	19	14			
<b>MXA 204</b>	2,8	1,6	<b>MXAM 204</b>	4,2	0,8	0,55	0,75			45	40	34	27	20	15		
<b>MXA 205</b>	4	2,3	<b>MXAM 205</b>	5,8	1,1	0,75	1			55,5	50	43	35,5	26,5	21,5	15,5	

	3 ~ 230 V 400 V		1 ~ 230 V		P <sub>1</sub>		P <sub>2</sub>		Q									
	A	A	A	kW	kW	HP	m <sup>3</sup> /h	l/min		0	2	3	4	5	6	6,5	7	8
<b>MXA 403</b>	2,8	1,6	<b>MXAM 403</b>	4,2	0,9	0,55	0,75	<b>H</b>	m	34	30	28	25	22	17	15		
<b>MXA 404</b>	3,5	2	<b>MXAM 404</b>	5,4	1,2	0,75	1			45	40	37	33	28	22	19	15	
<b>MXA 405</b>	5	2,9	<b>MXAM 405</b>	7	1,6	1,1	1,5			56	51	47,5	43	37,5	31,5	28	24,5	15,5

P1 Max. power input.

P2 Rated motor power output.

Test results with clean cold water, without gas content.  
+ 0,5 m security margin on NPSH-value is necessary.

Tolerances according to ISO 9906, annex A.

For capacities over 4 m<sup>3</sup>/h use a suction pipe G 1 1/4 (DN 32).

### Dimensions and weights

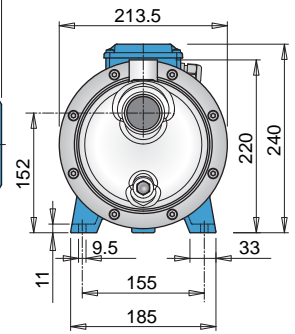
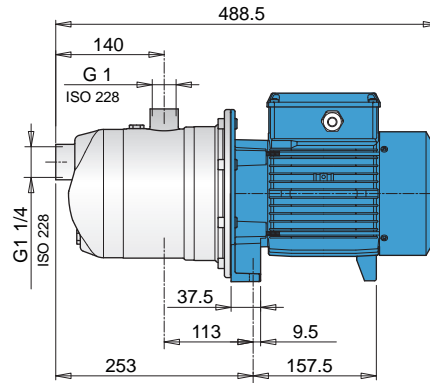
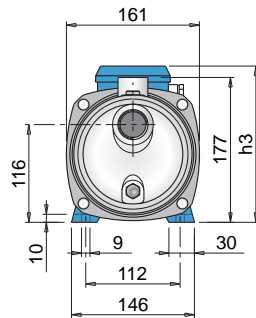
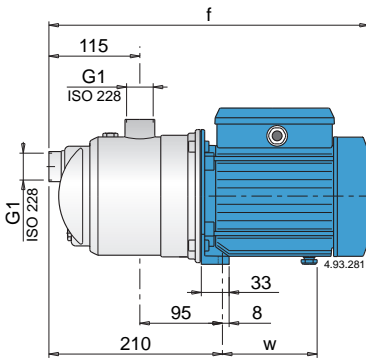

TYPE	mm			Net weight kg	
	f	h3	w	MXA	MXAM
<b>MXA 203 - MXAM 203</b>	362	176	102	6,6	6,7
<b>MXA 204 - MXAM 204</b>	391	188	112	8,7	9,6
<b>MXA 403 - MXAM 403</b>	391	188	112	8,6	9,5
<b>MXA 404 - MXAM 404</b>	391	188	112	9,5	10,5

TYPE	Net weight kg	
	MXA	MXAM
<b>MXA 205 - MXAM 205</b>	14	15,3
<b>MXA 405 - MXAM 405</b>	14,8	16,3

#### Extra safety

against running dry, with the suction port above pump axis and with the self-priming construction.

#### Robust

Single-piece barrel casing.

#### Compact

Single-piece lantern bracket and base.

#### Low noise

with the water-filled shroud around the stages.

