

INTEROBIZ

www.interobiz.ro



Construction

High-density polyethylene tank, 200 ltr capacity, resistant to corrosion, with minimum overall dimensions. Pump options GM 10 and GX series.

Delivery pipe-work with PVC connectors.

Assembly kit included.

Suitable for floor or below ground installation.

Easy pump access through large screwed cover.

Applications

Automatic waste water collecting and lifting stations, to handle domestic, civil and industrial waste water.

For collecting and lifting clean waste water and rain water.

For flood drainage.

Pumps

GM 10 : Submersible drainage pump constructed from composite polymers, with shaft of chrome steel AISI 430.

Liquid temperature up to 30 °C

2-pole induction motor, 50Hz (n = 2900 rpm), single-phase 230 V +/-10% with thermal protector and float switch for automatic operation.

5 m cable and control box with capacitor.

GX: Submersible sewage and drainage pumps in chrome-nickel stainless steel, with vertical delivery port.

GXC: with twin passage impeller

GXV: with free-flow (vortex) impeller

Liquid temperature up to 35 °C

2-pole induction motor, 50Hz (n = 2900 rpm), single-phase 230 V +/-10%, with thermal protector and float switch for automatic operation.

10 m cable and control box with capacitor.

Characteristics

TYPE	1 ~		Q max m³/h	H max m
	kW	A		
GEO-GM10	0,3	1,75	12	6,5
GEO-GXCM 40B	0,55	4,6	21	9
GEO-GXCM 40A	0,9	6,3	26	11,6
GEO-GXVM 40B	0,55	4,6	15	6,7
GEO-GXVM 40A	0,9	6,3	21	8,5

Pumps characteristics

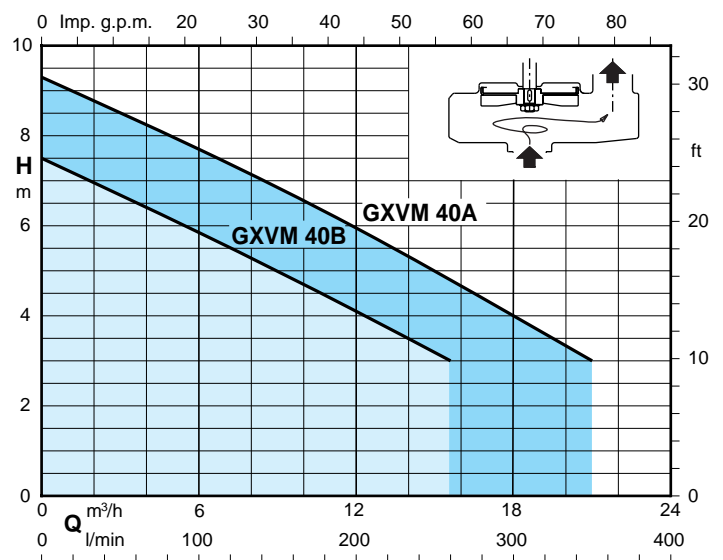
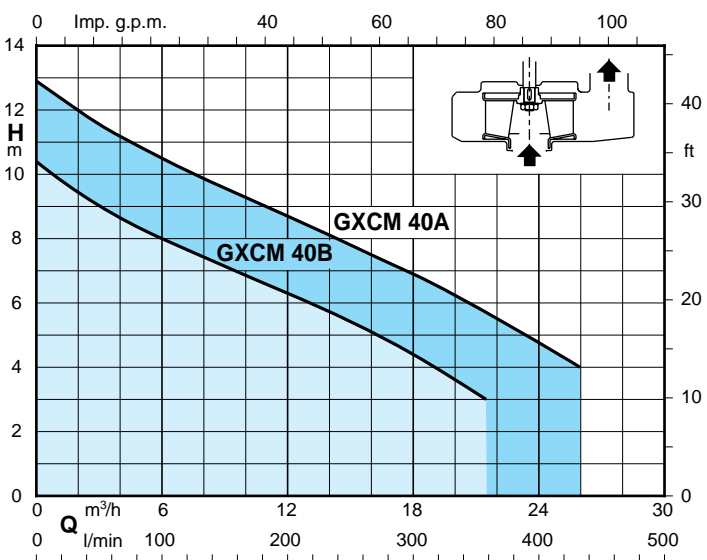
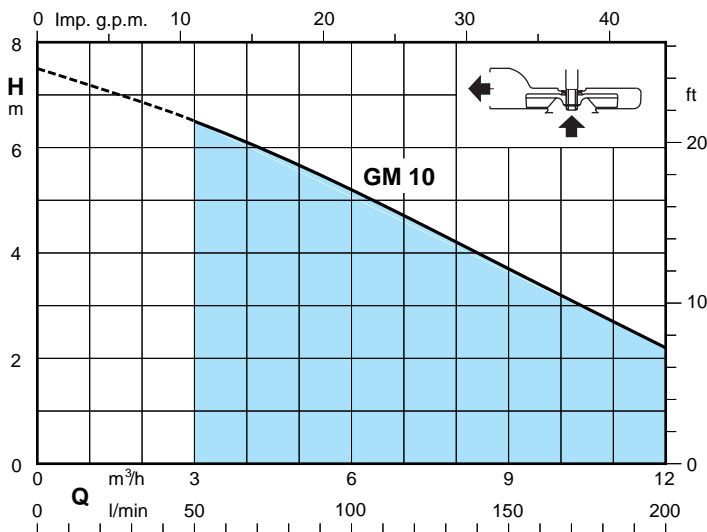

Dimensions and weights

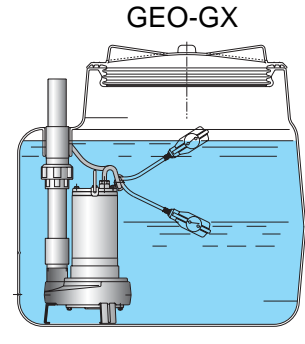
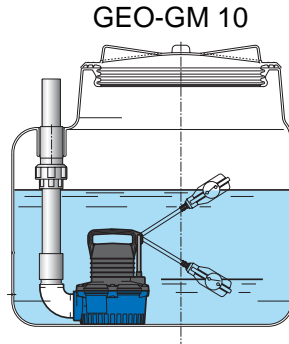
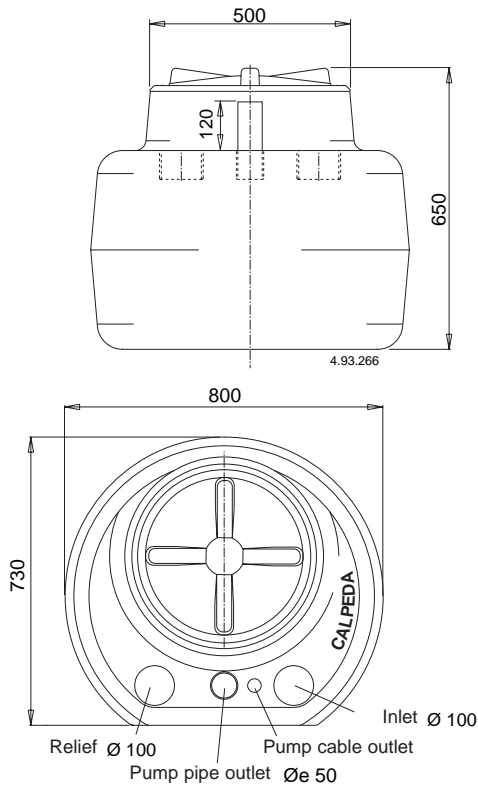

TYPE	kg
GEO-GM 10	19,8
GEO-GXCM 40B	26,5
GEO-GXCM 40A	27,7
GEO-GXVM 40B	26,2
GEO-GXVM 40A	27,5

Installation examples

